

KS TOOLS

*Tools and
more*



**LIGHTING
TOOLS**

K11



KS TOOLS®

*Tools and
more*



page 746 - 751

1

2

3

4

5

6

7

8

9

10

11

12

13

14

15

16

17

i

LED Cordless workshop lamp

- Particularly compact workshop hand lamp with 30 ultrabright LEDs
- Long duration of light efficiency independent of power
- Shock resistant
- Robust rubber coated housing
- Practical LED charge level indicator
- Supplied with intelligent charging station, for mobile charging application 12/24 V as well as stationary 110/220V

Technical data

Battery:	3.7V / 4400 mAh
Rechargeable battery:	Li-polymer
Capacity:	2.8 Watt
Charging voltage:	AC 100-240V ~ 50 / 60Hz, DC 12 - 28V
Charging time:	6h
Operating time:	10h
Weatherproof protection:	IP64
Service life:	~ 100.000h
Working temperature:	- 5°C / + 45°C
Weight:	0.9kg



LED (Light Emitting Diode)

Light emitting diodes are microstructural solid states and completely unsusceptible to vibrations. They last 1000 times longer than conventional light bulbs, unlike halogen lamps they produce no shades, hardly produce warmth and use less electricity. LEDs contain no harmful filling gases and produce no ultraviolet rays.

Power consumption

The power consumption of a lamp and their bright performance are two completely different things. The fact that a lamp uses a lot of energy by no means that they produce a lot of light. The largest part of the energy is still moved in warmth.

This is also applies to LEDs a high efficient 1 watt diode which can supply more light than one low quality 5 watt diode.

Light efficiency

1% Light* Flashlights light bulb 100 Hours*	1% Light** Light bulb 1000 Hours*	13% Light* High end LED 100,000 Hours***	13% Light* High end power chip 100,000 Hours***
--	--	---	--

* In this juncture, it is about calculated average values. According to type of the lamp abnormalities can occur. ** With 15 / 25 watt lamps. According to type of the lamp abnormalities can occur. *** After 100.000 working hours LEDs still shine with 50% of the brightness.

Lighting technology IP protection class

LEDMAX[®]

• The power saving and long life LED lighting program the excellent quality for the automotive area, construction and industry



IP Protection class identification mark

The housing protection degree, is fixed as the standards IEC 529 or DIN EN 60 52 which contain several different protection types. The illustration below shows an overview of the protection classes which are represented as follows.

Code character

(International protection)

IP

The first reference number

touch and foreign body protection

6

The second reference number

protection of the housing against the penetration of water

5

- If for the designation the 1st or 2nd place is not important, it is replaced by X.
- Perhaps 3rd place Additional touch protection / perhaps 4th place Supplementary character
- Representation in accordance to DIN VDE 0470, DIN EN 60 529, IEC 60529

IP Protection class definition

1. ref. number	range of protection
0	no touch protection, no protection against compact foreign objects
1	protection against extensive touch with hand protection against foreign objects Ø >50 mm
2	protection against touch with fingers protection against foreign objects Ø >12 mm
3	protection against touch with tools, wire etc with Ø >2,5 mm protection against foreign objects Ø >2,5 mm
4	protection against touch with tools, wire etc with Ø >1 mm protection against foreign objects Ø >1 mm
5	protection against touch protection against dust deposit inside
6	complete protection against touch protection against entry of dust

2. ref. number	range of protection
0	no protection against water
1	protection against vertical falling raindrops
2	protection against angular falling raindrops (every angle up to 15° to vertical)
3	protection against water in every angle up to 60° to vertical
4	protection against splash water from all directions
5	protection against jet of water (blast pipe) every angle
6	protection against temporary flooding
7	protection against ingress of water during temporary immersion
8	protection against pressure water during constant immersion

LED BALL POINT PEN

4 in 1 LED ball point pen

- Ball point pen
- LED lamp
- Laser pointer
- Handheld pencil
- With clip for the breast pocket
- Approx. 60 hours lamp duration
- Includes 4 x LP 41 button cell
- Impact proof housing



Item	L mm	D mm	
10010	150.0	15.0	110

2 in 1 LED ball point pen

- Ball point pen
- LED lamp
- With focus lens
- With clip for the breast pocket
- Approx. 60 hours lamp duration
- Includes 4 x LP 41 button cell
- Impact proof housing



Item	L mm	D mm	
10012	130.0	13.0	100

INSPECTION LAMPS

Flexible LED inspection lamp with extension

- LED lamp
- Flexible shaft
- Includes extension
- Approx: 60 hours lamp duration
- Includes 2 x AA batteries
- Impact proof housing



Item	L mm	D mm	Spare bulb	
550.1185	400.0	5.0	550.1187	120

Illuminated inspection mirror

- LED lamp
- Flexible shaft
- Adjustable by thumb pressure to 90°
- Approx. 60 hours lamp duration
- Includes 2 x AA batteries
- Stable plastic housing



Item	L mm	B mm	Mirror size mm	Spare bulb	
550.1138	600.0	40.0	38 x 73	550.1138	280

Flexible UV inspection lamp

- LED UV lamp
- Flexible shaft
- Localizes leaks in air conditioning systems
- With clip for the breast pocket
- Approx. 60 hours lamp duration
- Includes 3 x AAAA batteries
- Impact proof housing



Item	L mm	D mm	Spare bulb	
550.1165	450.0	7.5	550.1167	150

Flexible LED inspection set

- LED lamp
- Flexible shaft
- Includes flexible fibreglass attachment
- With clip for the breast pocket
- Includes single lamp bulb
- Approx. 60 hours lamp duration
- Includes 2 x LR 03 button cell + 2 x 1,5 V AAA batteries
- Impact proof housing



Item	L mm	B mm	H mm	Spare bulb	
550.1160	210.0	150.0	25.0	550.1161	230

LED FLASHLIGHT

LEDMAX flashlight S1

- Ideal for smock and shirt pocket
- Power Chip LED
- 25 Lumens luminous flux
- Variable hyper focus lens for spot to floodlight
- Ingress protection according to IPX3
- With clip for the breast pocket
- 10 - 20 hours lamp duration
- Includes 2 x AA 1,5 V batteries
- Ultra easy and impact proof aluminium housing



Item	L mm	D mm	
550.1205	138.0	15.0	50

FLASHLIGHTS

Basic workshop inspection hand lamp 8 watts

- Standard quality
- Plastic protection pipe
- Shock proof
- Plastic hand grip casing
- Revolving hooks for suspending
- Lamp extension tube not interchangeable
- Includes lamp



Technical data:
 Luminosity: 8 W
 Lamp length: 400 mm
 Connection cable length: 4 m
 Operational voltage: 230 V
 Protection class: -
 Weatherproof protection: -

Item	L mm	Spare bulb	kg
150.4205	400.0	390	

Pro workshop inspection hand lamp 8 watts

- Industrial quality
- Protection pipe out of polycarbonate
- Impact resistant impact strength IK09
- High quality rubber hand grip casing
- Revolving hooks for suspending
- With contour connector according to CEE 7/17
- Ingress protection according to IP54
- With integrated connector
- Lamp extension tube interchangeable
- Includes lamp



Technical data:
 Luminosity: 8 W
 Lamp length: 490 mm
 Connection cable length: 5 m
 Operational voltage: 230 V
 Protection class: II
 Weatherproof protection: IP54

Item	L mm	Spare bulb	kg
150.4208	490.0	150.4209	720

Pro workshop inspection hand lamp 11 watts

- Industrial quality
- Protection pipe out of polycarbonate
- Impact resistant impact strength IK09
- High quality rubber hand grip casing
- Revolving hooks for suspending with shaped plug according to CEE 7/17
- Ingress protection according to IP54
- With integrated connector
- Lamp extension tube interchangeable
- Includes lamp



Technical data:
 Luminosity: 11 W
 Lamp length: 395 mm
 Connection cable length: 5 m
 Operational voltage: 230 V
 Protection class: II
 Weatherproof protection: IP54

Item	L mm	Spare bulb	kg
150.4210	395.0	150.4211	720

Pro duo workshop inspection hand lamp with twin usage 11 watts

- Industrial quality
- Ideally usable as a focusable flashlight or work lamp
- Protection pipe out of polycarbonate
- Impact resistant impact strength IK09
- High quality rubber hand grip casing
- Revolving hooks for suspending
- With contour connector according to CEE 7/17
- Ingress protection according to IP54
- With integrated connector
- Lamp extension tube interchangeable
- Includes lamp



Technical data:
 Luminosity: 11 W
 Lamp length: 395 mm
 Connection cable length: 5 m
 Operational voltage: 230 V
 Protection class: II
 Weatherproof protection: IP54

Item	L mm	Spare bulb	kg
150.4215	395.0	150.4216	740

Pro XXL workshop inspection hand lamp 18 watts

- Industrial quality
- Protection pipe out of polycarbonate
- Impact resistant impact strength IK09
- High quality rubber hand grip casing
- Revolving hooks for suspending
- With contour connector according to CEE 7/17
- Ingress protection according to IP54
- 5 m connection cable
- With integrated connector
- Lamp extension tube interchangeable
- Includes lamp



Technical data:
 Luminosity: 18 W
 Lamp length: 765 mm
 Connection cable length: 5 m
 Operational voltage: 230 V
 Protection class: II
 Weatherproof protection: IP54

Item	L mm	Spare bulb	kg
150.4225	765.0	150.4226	860

Pro XXL under bonnet lamp with expanding bracket 36 watts

- Industrial quality
- Ideally for undisturbed working in the engine compartment
- Automatic adjustment between 110 - 170 cm
- With large, adjustable and rubber coated hooks
- Protection pipe out of polycarbonate
- Impact resistant impact strength IK09
- High quality rubber hand grip casing
- Revolving hooks for suspending
- With contour connector according to CEE 7/17
- Ingress protection according to IP54
- 5 m connection cable
- With integrated connector
- Lamp extension tube interchangeable
- Includes lamp



Technical data:
 Luminosity: 36 W
 Housing length: 1.377 m
 Connection cable length: 5 m
 Operational voltage: 230 V
 Protection class: II
 Weatherproof protection: IP54

Item	L mm	Spare bulb	kg
150.4250	1377.0	150.4249	1.16

Cable reel with pro workshop inspection hand lamp 11 watts

- Industrial quality
- Practical and space saving
- Controlled cable extending in different rest steps possible assembly levels
- Automatic return mechanism with endstopper
- Housing 180° freely revolving
- Protection pipe out of polycarbonate
- Impact resistant impact strength IK09
- High quality rubber hand grip casing
- Revolving hooks for suspending
- With contour connector according to CEE 7/17
- Ingress protection according to IP54
- With integrated connector
- Lamp extension tube interchangeable
- Includes lamp
- Metal wall reinforcement rail
- Blow mould plastic housing



Technical data:

Luminosity:	11 W
Lamp length:	490 mm
Connection cable length:	1,5 m
Work cable length m:	15 m
Operational voltage:	230 V
Protection class:	II
Weatherproof protection:	IP54

Item	L mm	Spare bulb	kg
150.4230	490.0	150.4211	7.00

Workshop cable reel

- Practical and space saving
- Extra strong, automatic return mechanism
- With endstopper
- 180° freely revolving
- Cable working length 15 m
- Connection cable 1,5 m
- Metal wall reinforcement rail 270 mm



Technical data:

Work cable length m:	15 m
Connection cable length:	1,5 m
Voltage:	230 V
Operational voltage:	12 V

Item	kg
150.4220 Workshop cable reel	7.00

Cable reel with LEDMAX workshop inspection hand lamp S8

- Industrial quality
- 60 Power Chip LED's
- Practical and space saving
- Controlled cable extending in different rest steps possible assembly levels
- Automatic return mechanism with endstopper
- Housing 180° freely revolving
- Protection pipe out of polycarbonate
- Impact resistant impact strength IK09
- High quality rubber hand grip casing
- Revolving hooks for suspending
- Ingress protection according to IP54
- Includes transformer
- Metal wall reinforcement rail
- Blow mould plastic housing

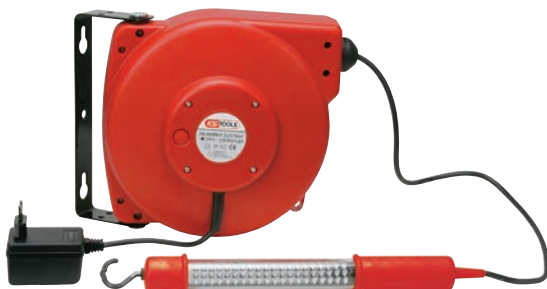

Technical data:

Luminosity:	148 Lux
Lamp length:	765 mm
Connection cable length:	1,5 m
Work cable length m:	15 m
Operational voltage:	230 V
Protection class:	-
Weatherproof protection:	IP54

Item	L mm	kg
150.4280	765.0	7.00

LED HAND LAMPS

LEDMAX rechargeable battery twin work lamp S11

- Ideal for network independent working
- 28 Power Chip LED operating lamps
- 4 Power Chip LED's pocket lamps
- Housing body covered with high quality rubber
- Ingress protection according to IP54
- Hook for suspending
- In 3 rest steps at 30° around 90° revolving
- Includes automatic turn off charging station
- 1 Hour charging time
- 5 Hours lamp duration operating lamp
- 35 Hours lamp duration flashlight
- Polycarbonate housing



Technical data:

Battery:	10,8 V / 1,5 Ah
Rechargeable battery:	Lithium-Ionen
Capacity:	200 Lux / 50 Lux
Charging voltage:	AC 100 - 240 V ~ 50 / 60 Hz
Working temperature:	-5° / +45°

Item	L mm	kg
150.4200	60.0	440

LEDMAX 110/220 V rechargeable battery work lamp S9

- Ideal for network independent working
- 30 Power Chip LED's
- Housing body covered with high quality rubber
- Ingress protection according to IP54
- Durable blow mould
- Revolving hooks for suspending
- With control LED to discharge
- Includes automatic turn off charging station
- 5-6 hours charging time
- 5-6 hours lamp duration
- Polycarbonate housing



Technical data:

Battery: 3,7 V / 4400 mAh
 Rechargeable battery: Li-polymer
 Capacity: 2,8 Watt
 Charging voltage: AC 100-240 V ~ 50 / 60 Hz
 Working temperature: -5° / +45°

Item	L mm	kg
150.4240	340.0	900

LEDMAX workshop hand lamp S7

- 30 Power Chip LED's
- Industrial quality
- Protection pipe out of polycarbonate
- Impact resistant impact strength IK09
- Rubber hand grip casing
- Revolving hooks for suspending
- Ingress protection according to IP54
- Includes transformer



Technical data:

Luminosity: 148 Lux
 Lamp length: 490 mm
 Connection cable length: 8 m
 Operational voltage: 230 V
 Protection class: -
 Weatherproof protection: IP54

Item	L mm	kg
150.4270	490.0	2.00

LEDMAX workshop hand lamp S8

- Industrial quality
- 60 Power Chip LED's
- Protection pipe out of polycarbonate
- Impact resistant impact strength IK09
- Rubber hand grip casing
- Revolving hooks for suspending
- Ingress protection according to IP54
- 8 m connection cable
- Includes transformer



Technical data:

Luminosity: 148 Lux
 Lamp length: 765
 Connection cable length: 8 m
 Operational voltage: 230 V
 Protection class: -
 Weatherproof protection: IP54

Item	L mm	kg
150.4275	765.0	2.00

LEDMAX 12/24 V + 110/220 V rechargeable battery work lamp S10

- 30 Power Chip LED's
- Industrial quality
- Also for mobile use (12/24 V)
- Ideal for very long network independent working
- Housing body covered with high quality rubber
- Ingress protection according to IP64
- Durable blow mould
- Revolving hooks for suspending
- With control LED to discharge
- Includes automatic turn off charging station
- 5 - 6 hours charging time
- 9 - 10 hours lamp duration
- Polycarbonate housing



Technical data:

Battery: 3,7 V / 4400 mAh
 Rechargeable battery: Li-polymer
 Capacity: 2,8 Watt
 Charging voltage: AC 100-240 V ~ 50 / 60 Hz
 DC 12-28 V
 Working temperature: -5° / +45°

Item	L mm	kg
150.4235	340.0	900



1
2
3
4
5
6
7
8
9
10
11
12
13
14
15
16
17
i

WORK LAMPS

Pro workshop inspection hand lamp 36 watt

- Industrial quality
- 2.900 lumens luminous flux
- Polycarbonate protection glass
- Housing cover also rubber
- Impact resistant impact strength IK10
- Hooks for double sided applications and with contour connector according to CEE 7/17
- Ingress protection according to IP54
- With integrated connector
- Lamp extension tube interchangeable
- Includes lamp
- Blow mould plastic housing



Technical data:

Luminosity:	36 W
Connection cable length:	5 m
Operational voltage:	230 V
Accessory outlet:	-
Protection class:	II
Weatherproof protection:	IP54

Item	H mm	B mm	T mm	Spare bulb	kg
150.4255	230.0	340.0	110.0	150.4256	2.36

Pro workshop inspection hand lamp 108 watt

- Industrial quality
- 8.700 lumens luminous flux
- With 1 x 230 V isolated outlet on the back
- Polycarbonate protection glass
- Housing cover also rubber
- Impact resistant impact strength IK10
- Hooks for double sided applications and pedestal with contour connector according to CEE 7/17
- Ingress protection according to IP44
- With integrated connector
- Lamp extension tube interchangeable
- Includes lamp
- Blow mould plastic housing



Technical data:

Luminosity:	108 W
Connection cable length:	5 m
Operational voltage:	230 V
Accessory outlet:	1 x 230 V Schuko
Protection class:	II
Weatherproof protection:	IP44

Item	H mm	B mm	T mm	Spare bulb	kg
150.4265	290.0	500.0	110.0	150.4261	5.82

Pro workshop inspection hand lamp 72 watt

- Industrial quality
- 5.800 lumens luminous flux
- With 2 x 230 V isolated outlet on the back
- Polycarbonate protection glass
- Housing cover also rubber
- Impact resistant impact strength IK10
- Hooks for double sided applications and pedestal with contour connector according to CEE 7/17
- Ingress protection according to IP44
- With integrated connector
- Lamp extension tube interchangeable
- Includes lamp
- Blow mould plastic housing



Technical data:

Luminosity:	72 W
Connection cable length:	5 m
Operational voltage:	230 V
Accessory outlet:	2 x 230 V Schuko
Protection class:	II
Weatherproof protection:	IP44

Item	H mm	B mm	T mm	Spare bulb	kg
150.4260	285.0	495.0	110.0	150.4261	5.02

Pro LED inspection hand lamp 10 watts

- Industrial quality
- 168 Power Chip LED's
- With 1 x 230 V isolated outlet on the back
- Polycarbonate protection glass
- Housing cover also rubber
- Impact resistant impact strength IK10
- Hooks for double sided applications and pedestal with contour connector according to CEE 7/17
- Ingress protection according to IP54
- 5 m connection cable
- Blow mould plastic housing



Technical data:

Luminosity:	10 W
Connection cable length:	5 m
Operational voltage:	230 V
Accessory outlet:	1 x 230 V Schuko
Protection class:	II
Weatherproof protection:	IP54

Item	H mm	B mm	T mm	kg
150.4266	355.0	225.0	140.0	2.05



Extending tripod for work lamps

- Universal tripod for work lamps
- Expandable through optional extensions
- Optimal illuminating guaranteed
- Secure stand
- Extremely compact transportation size
- On fold away tripod foot part
- Fully adjustable through 2 wing screws
- Work height 1,0 to 2,7 m
- With cable holder device
- Galvanised steel pipe



Item	H mm	Castor wheel set	kg
150.4267	1000 - 2700	150.4268	5.92

Castor wheel sets for 150.4267

- 3 castor wheels with special rubber tyre
- Includes reinforcement screw
- With backing plate on every castor

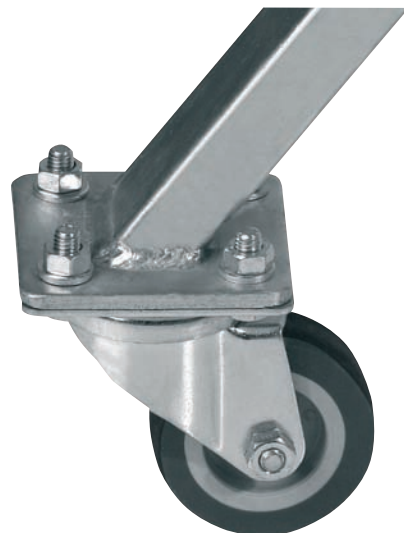

Item	kg
150.4268 3 pcs Castor wheel sets for 150.4267	1.00

ACCESSORIES

Magnet holder for workshop lamps

- Universal mounting clip for workshop lamps
- Extra large pivoting range
- Magnet completely rubberised
- Stop peg out of spring steel



Item	D1 mm	D2 mm	kg
150.4219	43.0	31.0	120

Scaffolding clamp for work lamps

- Universal scaffolding clamp for cold light work lamps
- For all current scaffoldings and pipes up to 50 mm
- Heavy and robust execution
- Zinc coated steel tube



Item	Ø mm	kg
150.4269	50,0	1.06

item	page	item	page	item	page		
1		515.3066	727	515.3540	738		
10010	746	515.3070	722	515.3545	738		
10012	746	515.3075	724	515.3549	726		
140.2219	727	515.3080	719	515.3550	738		
140.2251	727	515.3085	719	515.3551	726		
150.4200	741, 748	515.3090	720	515.3552	726		
150.4205	747	515.3100	728	515.3553	726		
150.4208	747	515.3101	724	515.3555	738		
150.4210	747	515.3102	724	515.3560	739		
150.4215	747	515.3198	725	515.3565	739		
150.4219	751	515.3310	733	515.3570	739		
150.4220	748	515.3315	733	515.3575	739		
150.4225	747	515.3320	733	515.3580	740		
150.4230	748	515.3330	733	515.3590	740		
150.4235	741, 749	515.3335	733	515.3591	740		
150.4240	740, 749	515.3340	733	515.3592	740		
150.4250	747	515.3344	733	515.3597	740		
150.4255	750	515.3345	733	515.3598	740		
150.4260	750	515.3346	733	515.3599	740		
150.4265	750	515.3350	729	515.3710	716		
150.4266	750	515.3355	729	515.3715	717		
150.4267	751	515.3356	729	515.3720	717		
150.4268	751	515.3360	730	515.3725	717		
150.4269	751	515.3361	730	515.3735	718		
150.4270	749	515.3365	731	515.3750	718		
150.4275	749	515.3370	730	515.3765	719		
150.4280	748	515.3375	731	515.3770	719		
152.1060	728	515.3380	731	515.3810	722		
3		515.3381	731	515.3840	722		
310.0130	716	515.3382	731	515.3900	728		
310.0131	716	515.3383	731	550.1035	729		
310.0135	716	515.3384	731	550.1138	746		
5		515.3385	731	550.1160	746		
515.1205	721	515.3386	731	550.1165	746		
515.1206	721	515.3387	731	550.1185	746		
515.1215	718	515.3388	731	550.1205	746		
515.1220	718	515.3389	731	550.1601	743		
515.1243	726	515.3390	731	550.1602	743		
515.1244	726	515.3391	731	550.1603	743		
515.1275	716	515.3392	731	550.1604	743		
515.1285	726	515.3394	730	550.1610	741		
515.1290	717	515.3395	730	550.1620	741		
515.1300	721	515.3396	730	550.1630	742		
515.1301	721	515.3480	730	550.1640	742		
515.1303	721	515.3481	730	550.1650	742		
515.1901	732	515.3482	730	550.1660	742		
515.1902	732	515.3483	730	550.1665	743		
515.1903	732	515.3484	730	9			
515.1904	732	515.3485	730	980.1070	729		
515.1907	732	515.3486	731				
515.1908	732	515.3487	731				
515.1921	732	515.3488	731				
515.1930	732	515.3489	730				
515.1950	729	515.3490	730				
515.1960	729	515.3491	730				
515.1965	728	515.3492	731				
515.3000	723	515.3493	731				
515.3005	725	515.3494	731				
515.3010	725	515.3495	731				
515.3015	725	515.3496	731				
515.3020	726	515.3497	731				
515.3025	720	515.3500	736				
515.3030	720	515.3505	736				
515.3035	722	515.3510	736				
515.3040	723	515.3515	736				
515.3045	724	515.3520	737				
515.3050	723	515.3525	737				
515.3055	723	515.3530	737				
515.3061	727	515.3535	737				



Werkzeuge-Maschinen GmbH

Seligenstädter Grund 10 - 12

Industriegebiet Ost 1

D- 63150 Heusenstamm



DEUTSCHLAND

Tel.: +49 6104 4974-0

Fax: +49 6104 4974-11

e-mail: kstools@kstools.de

URL: www.kstools.de